

External Wall Insulation

Care Guide



You External Wall System

InstaClad Robust – an external solid wall insulation system utilising EPS insulation, a reinforcing mesh and a decorative finish of either silicone render or dry dash (approximate total thickness of install 115mm). The system also includes insulated Reveal details installed around windows and doors. Roof lines and party lines are capped accordingly to ensure the system is sealed and weather tight.

Whilst the system is very robust, the 1.5mm render finish is susceptible to minor surface damage if knocked with items such as ladders & bicycles.

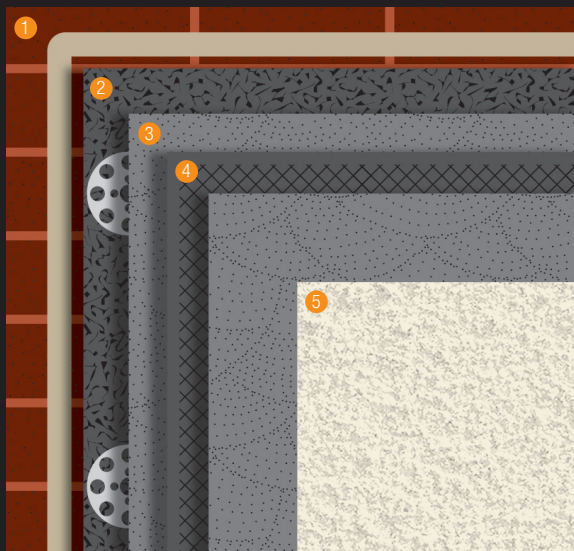

1. Adhesive

2. Insulation - Grey EPS insulation board

3. Reinforcement Coat - Cementitious

4. Reinforcement Mesh

5. Render Finish - Silicone or Dry Dash

General Care Instructions

1. A render finish can be washed off with standard water. Do not use an abrasive brush or chemical cleaners on the finish.
2. Surface can be re-decorated with manufacturers recommended finish. DO NOT use off the shelf paint as this will affect the durability of the product and invalidate the warranty.
3. Silicone Seals can be wiped clean with standard water. Do not use an abrasive brush or chemical cleaners on the seals. Seals should never be replaced without consultation with the manufacturer. Leaving these untreated or treating them with unsuitable materials will affect the durability of the product and invalidate the warranty.
4. Ensure water is not left to drip continuously onto the surface. Leaks may occur at downpipe joints, overflowing gutters, overflow pipes etc. These should be repaired immediately as continuous water leaks can cause staining in that area.
5. Avoid leaning any items, especially heavy goods against the finish for long periods of time. Along with the physical impact, staining can occur behind these items.
6. Plants, trees, soil & creepers can all cause staining to the finish. A regular maintenance of washing affected areas (See Above) will avoid long term dirt & algae build up. Fixing of climbers is detailed in the next section.
7. The System is designed to be robust but can be damaged by heavy or continuous impact. Ensure wheelie bins, bikes, heavy objects etc are clear of the system when being moved. Also ensure ladders etc are placed against the wall rather than slammed. Repair works are detailed in the next section.
8. Standard graffiti removal cleaners may not be suitable for use on the system finish. Please refer to system manufacturer if required.
9. Use of blow torches, solvents etc in the vicinity of the system is not advised. If necessary, ensure the system is suitably protected.



Minor Works & Maintenance

Small penetrations such as tacks for cables or climbers can be inserted through the render. Ensure a clean penetration trying to avoid several attempts or additional damage to the render. For added protection, cover each fixing and surrounding area with a good quality acrylic sealant.



Small patches of surface damage can be re-rendered with material sourced from original installer or system manufacturer. Do not use render that is not approved with this system. Remove any flaked or damaged render and brush in new render ensuring good coverage and overlap of the joints. Please note, due to weathering it is difficult to achieve a full colour match in these areas.

If the damage is more than surface based we strongly recommend contacting the installer. The board surface can be sealed, re-primed and rendered but suitable materials are required for each process.

Damage that has penetrated the board and broken the insulation will need to be referred back to the installer. These remedial works become major works and we do not recommend that you fix these yourself.

Ensure that any damage, no matter how minor, is addressed quickly to maintain the integrity of the system.

External Fixings & Major Works

Fixing of hanging baskets, television aerials, burglar alarms, satellite dishes, mail boxes etc post insulation install need careful consideration. Each item requires different length fixings, additional support and suitable remedial works.

There are two options for external fixings:

1. Using the Insta Mounting Blocks - inserted into area, these are specifically designed to take cantilevered fixings
2. Fix a spread load plate on the top of the system with fixings penetrating back through to the original substrate. Suitable sealing around the fixings will be required.

Neither options are a DIY job and ideally would be done by the original installer, alternatively a building professional.



Where the system needs penetrating to install additional pipe work, cables etc both the installer and system manufacturer need to be consulted two weeks prior to works commencing. There is a need to liaise with all parties to ensure that the undertaken works are satisfactorily completed.

When installing new windows and doors within the system both the installer and system manufacturer need to be consulted two weeks prior to works commencing. An install method needs to be agreed and all remedial works are to be undertaken by the system installer under the instruction of the manufacturer.

Please note: If works that fall under the Major Works category are undertaken without prior consultation with the installer and/or the manufacturer all warranties & guarantees become null & void.

